



Ultra PFC Choke



APPLICATION:

- Power Supply
- Server/Work Station
- Industrial PC

FEATURES

- A New Design Structure Core
- Very large section area (Ae)
- High Power Density and High Efficiency
- The larger Winding Space
- Optimal utilization of core and copper
- Large current is achieved in a small shape
- High performance realized by new Structure
- Excellent field shielding for EMI

◆ Watt correspond TP core:

Watt\Type	TP2618	TP3014	TP3020	TP3125	TP3130
750~1KW					V
500~750W				V	
350~650W			V		
150~350W	V	V			

◆ Dimensional specifications:

Unit : mm

	A Max	H Max	C Max	E	Pin Pitch (Pin No.)	φd
TP2618	28.0	32.0	19.0	15.5	6.6(6P)	0.8
TP3014	31.5	32.0	15.0	9.0	6.6(6P)	0.8
TP3020	31.5	32.0	21.0	15.5	6.6(6P)	0.8
TP3125	32.5	32.0	26.0	20.0	6.6(6P)	0.8
TP3130	32.5	32.0	31.0	25.0	3.8/5.6(8P)	1.0

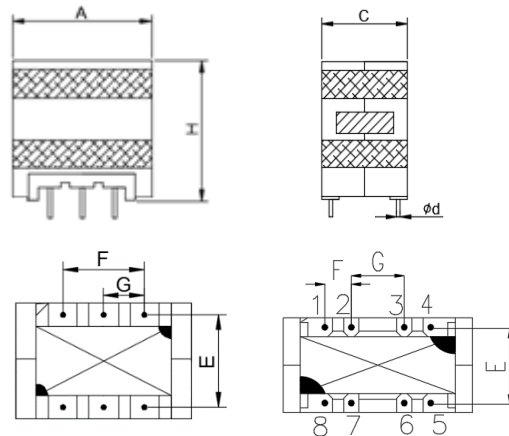

◆ Part number construction

TPA 3125- 221 - 56 - B - 00



- ① Series name
- ② Core shape
- ③ Inductance code
- ④ Internal code
- ⑤ Pin discrimination
- ⑥ Internal code

德特蒙有限公司 Tech Mount

www.techmount.com.tw

TEL:02-8228-7278 FAX:02-2225-3896

E-mail: sales@techmount.com.tw

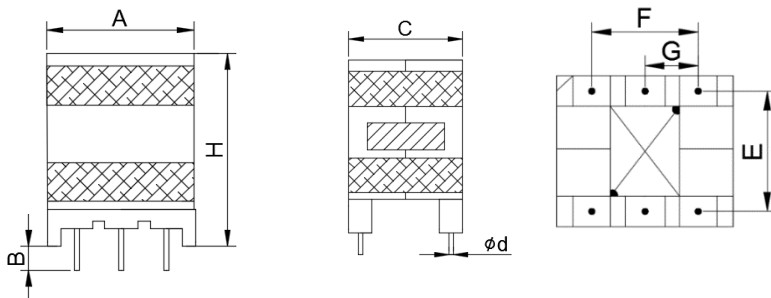

◆ Dimensional specifications:

Unit : mm

	A Max	H Max	B Max	C Max	E	G	φd
TP2618	28.0	32.0	4.0	19.0	15.5	6.6	0.8

◆ Electrical specifications:

Part Number	外觀尺寸(MAX)			L(μH)	DCR(mΩ)Max	I (L@80%)A
	A(mm)	C(mm)	H(mm)			
TP2618151AK0	28.0	19.0	32.0	150.0	64.1	11.5
TP2618181AJ0	28.0	19.0	32.0	180.0	105.6	13.5
TP2618201AJ1	28.0	19.0	32.0	200.0	105.6	12.5
TP2618231BD0	28.0	19.0	32.0	230.0	105.6	8.0
TP2618281AK0	28.0	19.0	32.0	280.0	137.8	9.0
TP2618401AJ1	28.0	19.0	32.0	400.0	209.6	9.0

If you require another part number please contact with us.

*All test data is referenced to 25° C ambient

*Inductance Tolerance +/- 10%

*Test condition:40KHz,0.3V

◆ DC-Bias property:

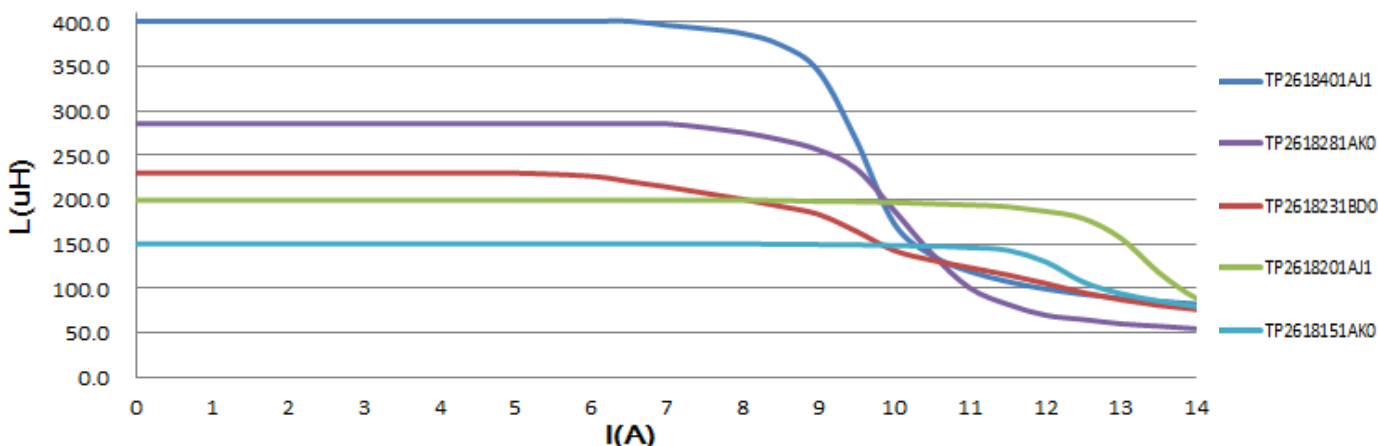

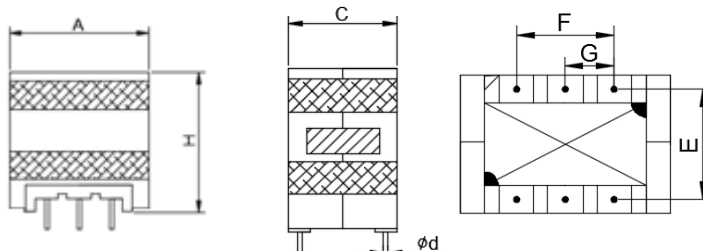

◆ Dimensional specifications:

Unit : mm

	A Max	H Max	C Max	E	G	φd
TP3020	31.5	32.0	21.0	15.5	6.6	0.8

◆ Electrical specifications:

Part Number	外觀尺寸(MAX)			L(μH)	DCR(mΩ)Max	I (L@80%)A
	A(mm)	C(mm)	H(mm)			
TP3020501AK1	31.0	21.0	32.0	500.0	101.6	5.5
TP3020401AJ0	31.0	21.0	32.0	400.0	173.1	9.5
TP3020361AK0	31.0	21.0	32.0	360.0	101.6	8.0
TP3020301AH0	31.0	21.0	32.0	300.0	173.1	13.0
TP3020271BK0	31.0	21.0	32.0	270.0	79.7	9.5
TP3020251AH1	31.0	21.0	32.0	250.0	125.5	12.5
TP3020221AJ1	31.0	21.0	32.0	220.0	74.5	11.5

If you require another part number please contact with us.

*All test data is referenced to 25° C ambient

*Inductance Tolerance +/- 10%

*Test condition:40KHz,0.3V

◆ DC-Bias property:

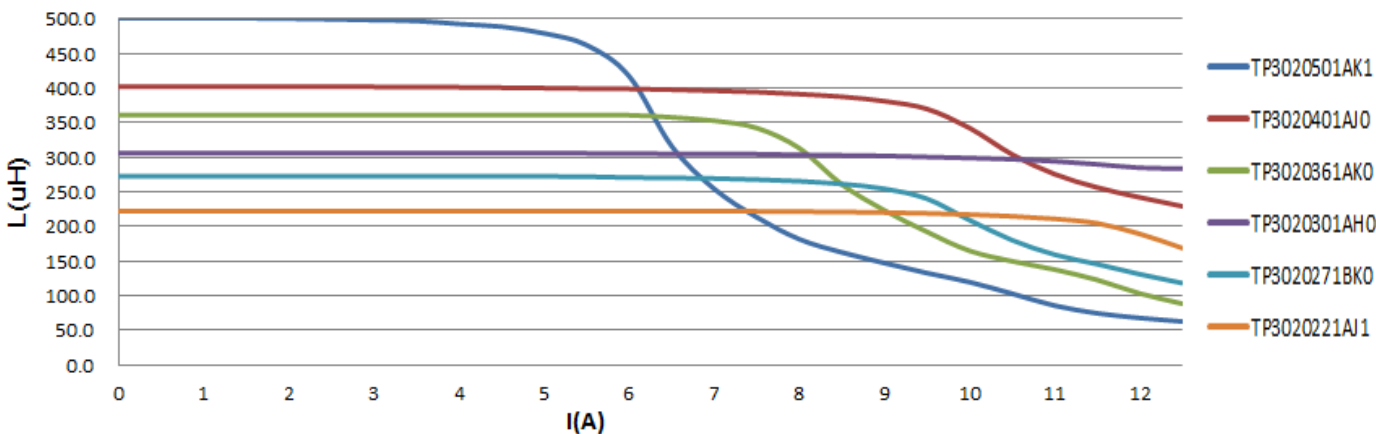

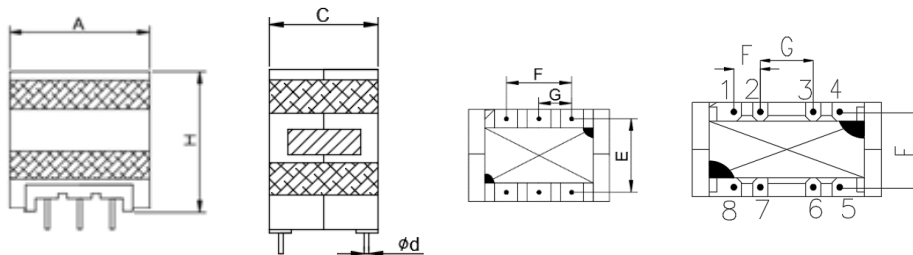

◆ Dimensional specifications:

Unit : mm

	A Max	H Max	C Max	E	G	φd
TP3125	32.5	32.0	26.0	20.0	6.6(6P)	0.8
TP3130	32.5	32.0	31.0	25.0	3.8/5.6 (8P)	1.0

◆ Electrical specifications:

Part Number	外觀尺寸(MAX)			L(μH)	DCR(mΩ)Max	I (L@80%)A
	A(mm)	C(mm)	H(mm)			
TP3125321AN0	32.0	26.0	32.0	320.0	121.7	13.0
TP3125241BD0G0	32.0	26.0	32.0	240.0	102.2	16.5
TP3125221BD0G1	32.0	26.0	32.0	220.0	80.5	14.0
TP3125201AN0	32.0	26.0	32.0	200.0	78.1	15.5
TP3125161BD0G0	32.0	26.0	32.0	160.0	66.5	20.0
TP3130211BH0	32.0	31.0	32.0	210.0	66.8	16.0
TP3130191BG0	32.0	31.0	32.0	190.0	83.6	20.0
TP3130151BG0	32.0	31.0	32.0	150.0	66.8	20.0

If you require another part number please contact with us.

*All test data is referenced to 25° C ambient

*Inductance Tolerance +/- 10%

*Test condition:40KHz,0.3V

◆ DC-Bias property:

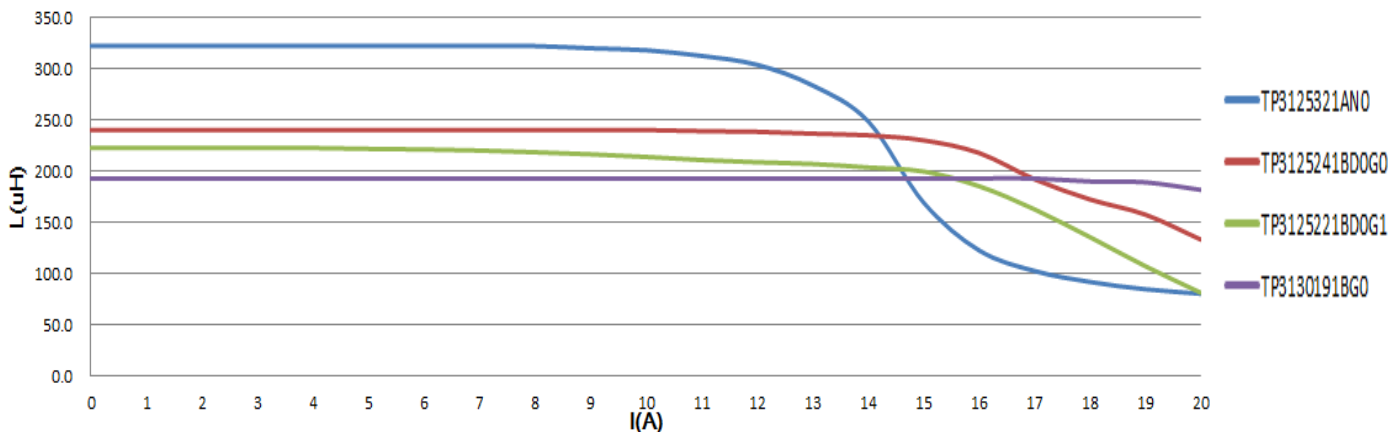

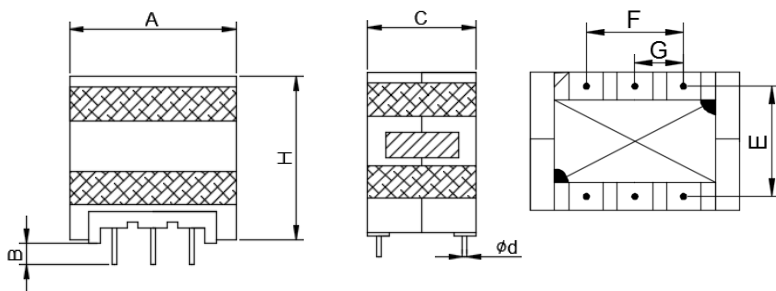

◆ Dimensional specifications(mm):

Unit : mm

	A Max	H Max	B Max	C Max	E	G	φd
TPA2618	28.0	32.0	4.0	19.5	15.5	6.6	0.8
TPA3020	31.5	32.0	4.0	21.0	15.5	6.6	0.8
TPA3125	32.5	32.0	4.0	26.0	20.0	6.6	0.8

◆ Electrical specifications:

Part Number	外觀尺寸(MAX)			L(μH)	DCR(mΩ)Max	I (L@80%)A
	A(mm)	C(mm)	H(mm)			
TPA2618231-44-B	28.0	19.0	32.0	230.0	103.8	8.0
TPA2618271-48-B	28.0	19.0	32.0	270.0	131.2	7.5
TPA3020221-38-B	31.0	21.0	32.0	220.0	81.8	11.0
TPA3020401-56-B	31.0	21.0	32.0	400.0	177.5	9.0
TPA3125221-45-C	32.0	26.0	32.0	220.0	82.7	12.5
TPA3125321-54-C	32.0	26.0	32.0	320.0	117.2	10.5

If you require another part number please contact with us.

*All test data is referenced to 25° C ambient

*Inductance Tolerance +/- 10%

*Test condition:40KHz,0.3V

◆ DC-Bias property:

